

1614-247

COFFEE GRINDER OPERATING INSTRUCTION

The Parameters of coffee Grinder

Product model	1614-247
Dimensions:	L205×W152×H372mm
GW/ NW	GW/NW: 9.5/5.6Kg
Burrs diameter	64mm(Flat Burrs)
Technical parameter	220-240V 50Hz, 220W
Hopper capacity	550g

Characteristics of 1614-247



Pisa tilt
Inspired by Tower of Pisa
Inclined design makes
powder drop faster



Push switch
220W/1400 RPM
Noise reduction



Air blowing structure
Air patting device under
the hopper cover
Lower residual powder



Multiple adjustment
The interval for one lifting
circle is 0.8mm.
90 scale levels are adjustable



Italy imported burrs
64mm flat burrs
Stable and fast
powder



Flexible base
The container cup can be
placed on the base or on the
cup holder. Meet different
requirements of users

The Description of the Parts

Coffee grinder×1 Air blowing ring×1 Hopper lid×1

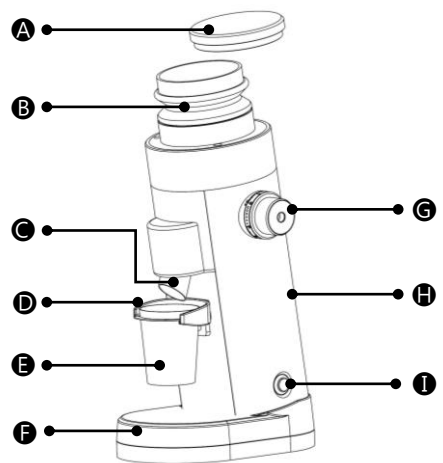

- A Hopper lid
- B Air blowing ring
- C Powder outlet
- D Cup holder
- E container cup
- F Base
- G Grind dial
- H Main body
- I On/off switch

The Instruction of Coffee Grinder

Please weight the required amount of coffee beans firstly because the device will grind all beans inside at once.



1

Put the container cup on the cup holder or on the base (Right below the powder outlet). Press the on/off switch, and start the machine. Adjust the grinding degree based on the "Adjustment of Grinding Degree".



2

Pour the weighted coffee beans in, and close the hopper lid.



3

Press the hopper lid times with hands after grinding, to clean the residual powder thoroughly.

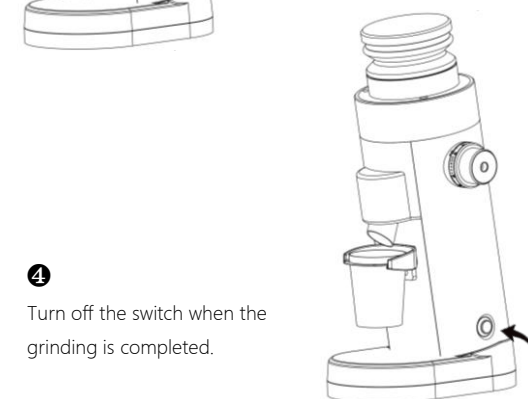

4

Turn off the switch when the grinding is completed.

Adjustment of Thickness

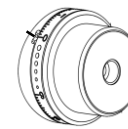

- There are 90 grinding degrees for users to choose from by rotating the plate dial with different degrees.
- The little arrow on the plastic base of the adjustment disc indicates the current grinding degree.
- The smaller the number, the finer the grinding degree is. Otherwise, the powder will become coarse.

Cautions

- Don't put the machine close to gas stove, electric stove or fire.
- Plastic bags are not toys and can be dangerous. To avoid any risk of suffocation.
- keep bags out of reach of children. Remove the plastic films and the bags before using.
- Do not wash any parts of the main body, except for the blowing rings.
- Clean with brushes and air blowers after using.
- Don't use this product for other purposes except for grinding coffee beans.
- Don't push fingers into the discharging unit or hopper before the machine is power off.
- If the power cord is damaged, it must be replaced with special guidance.

Cleaning and Maintenance

Please consult professional customer service for guidance. Warranty (one year for the electric parts) is excluded for all kinds of damages and losses caused by individual disassembly and assembly behaviors.

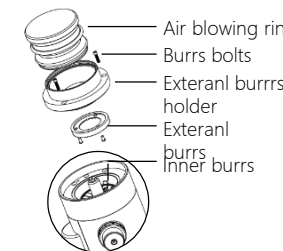

1 Remove burrs

1. Take away the air blowing ring and the hopper lid after thoroughly grinding.
2. Unscrew counterclockwise the three Locating dial bolts on the external burr holder and remove it.

3. Unscrew the external burr and the fixing bolts on the inner burr. Then remove external burr.

2 Clearance

1. Disconnect the power cord and remove the burrs away. (Refer to "Remove burrs" step).
2. Use the air blower and the brush to clean burrs and the inside of the coffee grinder.
3. After completely cleaning, put the spare parts together to the grinder sequentially.

3 Replacement of burrs

1. Disconnect the power cord and remove the burrs.
2. Install the inner burr to the burr holder and tighten the bolts.
3. Install the external burr to the burr holder and tighten the bolts.
4. Install the external burr holder with the machine body and restore the three locating dial bolts. The burrs are replaced successfully.

1 Soi Boromratchonnee 53, Boromratchonnee RD.,
Talingchan, Talingchan, Bangkok 10170
Tel : 02-880-8138-9
E-mail: koffeeart@gmail.com
Web: www.koffeeart.com